

SECTION AT RIGHT ANGLE TO EXISTING MAIN

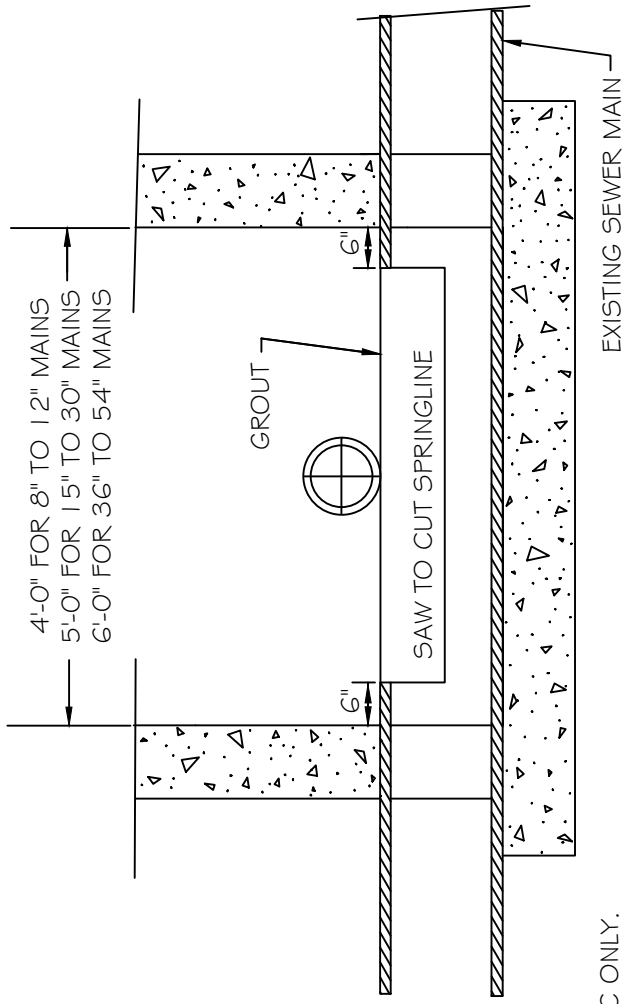

SECTION ALONG CENTERLINE OF EXISTING MAIN

- NOTES:
1. FLOW SHALL BE MAINTAINED DURING CONSTRUCTION.
  2. THIS DETAIL TO BE USED WHEN A 6" OR LARGER LATERAL NECESSITATES CONSTRUCTION OF A NEW MANHOLE.
  3. SEE STANDARD DETAIL S-20, FOR PRECAST MANHOLES.
  4. THE CONTRACTOR SHALL PROVIDE A MINIMUM 9" COMPACTED # 67 STONE BASE.
  5. FOR USE ON DIP, CONCRETE, AND PVC ONLY. (NOT ALLOWED ON VCP)
  6. SEE DETAIL S-2-1 FOR REINFORCING OF POURED IN-PLACE BASE

CITY OF RALEIGH				
DEPARTMENT OF PUBLIC UTILITIES				
STANDARD MANHOLE INSTALLATION OVER EXISTING SEWER MAIN				
DWG. NO.	REVISIONS	DATE	REVISIONS	DATE
S-22	Y.C.A.	12-31-91	A.B.B.	1-19-05
	RRH	3-30-00	D.H.L.	6/16/08