

RHDC
RALEIGH HISTORIC
DEVELOPMENT COMMISSION

CERTIFICATE OF APPROPRIATENESS PLACARD

for Raleigh Historic Resources

Project Description:

Remove damaged tree and replace

327 E Jones St

Address

Oakwood

Historic District

Historic Property

COA-0055-2019

Certificate Number

5/20/2019

Date of Issue

11/20/2019

Expiration Date

This card must be kept posted in a location within public view until all phases of the described project are complete. The work must conform with the code of the City of Raleigh and laws of the state of North Carolina. When your project is complete, you are required to ask for a final zoning inspection in a historic district area. Telephone the RHDC office at 832-7238 and commission staff will coordinate the inspection with the inspections Department. If you do not call for this final inspection, your Certificate of Appropriateness is null and void.

Signature, _____

Collette R Kinne

Raleigh Historic Development Commission

Pending the resolution of appeals, commencement of work is at your own risk.



Certificate of Appropriateness | Application

Development Services Customer Service Center • One Exchange Plaza, Suite 400 | Raleigh, NC 27601 | 919-996-2495

This form can be submitted in person or via USPS at the above address.

Type or print the following:		
Applicant name: Timothy Fennell		
Mailing address: 327 East Jones St		
City: Raleigh	State: NC	Zip code: 27601
Date: April 29, 2019	Daytime phone #: 919 622 4582	
Email address: tfennell327@gmail.com		
Applicant signature: <i>Timothy R Fennell</i>		
<input checked="" type="checkbox"/> Minor work (staff review) – one copy Major work (COA committee review) – one copy (10 copies will be required after initial staff review) <ul style="list-style-type: none"> <input type="checkbox"/> Additions > 25% of building sq. footage <input type="checkbox"/> New buildings <input type="checkbox"/> Demolition of building or structure <input type="checkbox"/> All other <input type="checkbox"/> Post approval re-review of conditions of approval	<p style="text-align: center;">Office Use Only</p> Transaction #: <i>594667</i> File #: <i>COA-0055-2019</i> Fee: <i>\$30.00</i> Amount paid: \$ _____ Received date: _____ Received by: <i>Natasha</i>	
Property street address: 327 East Jones St		
Historic district: Oakwood		
Historic property/Landmark name (if applicable):		
Owner name: Susan Sumner and Timothy Fennell		
Owner mailing address: 327 East Jones St, Raleigh NC 27601		

For applications that require review by the COA Committee (major work), provide addressed and stamped envelopes for owners for all properties with 100 feet on all sides of the property, as well as the property owner.

Property Owner Name & Address	Property Owner Name & Address

I understand that all major work applications that require review by the Raleigh Historic Development Commission's COA Committee must be submitted by 4 p.m. on the date of the application deadline; otherwise, consideration will be delayed until the following committee meeting. An incomplete application will not be accepted.

Will you be applying for rehabilitation tax credits for this project? Yes <input type="checkbox"/> No <input checked="" type="checkbox"/> Did you consult with staff prior to filing the application? Yes <input type="checkbox"/> No <input checked="" type="checkbox"/>	Office Use Only Type of work: <u>FL</u>
------------------------------------------------------------------------------------------------------------------------------------------------------------------------------------------------------------------------------------------------------------------------------------	---------------------------------------------------

Design Guidelines: please cite the applicable sections of the design guidelines (www.rhdc.org).		
Section/Page	Topic	Brief description of work (attach additional sheets as needed).
1.3.5/23	Site Features and Plantings	Replace a severely damaged tree with a new tree of a similar or identical species of appropriate scale.
See attached description		

Minor Work Approval (office use only)	
Upon being signed and dated below by the Planning Director or designee, this application becomes the Minor Work Certificate of Appropriateness. It is valid until <u>11/20/2019</u> .	
Please post the enclosed placard form of the certificate as indicated at the bottom of the card. Issuance of a Minor Work Certificate shall not relieve the applicant, contractor, tenant, or property owner from obtaining any other permit required by City Code or any law. Minor Works are subject to an appeals period of 30 days from the date of approval.	
Signature (City of Raleigh) <u>Collette R K</u>	Date <u>05/20/2019</u>

To be completed by applicant			Office Use Only		
	Yes	N/A	Yes	No	N/A
Attach 8-1/2"x11" or 11"x17" sheets with written descriptions and drawings, photographs, and other graphic information necessary to completely describe the project. Use the checklist below to be sure your application is complete. Minor Work (staff review) – 1 copy Major Work (COA Committee review) – 1 copy (10 copies will be required after initial staff review).	<input checked="" type="checkbox"/>		<input checked="" type="checkbox"/>	<input type="checkbox"/>	<input type="checkbox"/>
1. Written description. Describe clearly and in detail the nature of your project. Include exact dimensions for materials to be used (e.g. width of siding, window trim, tree species, etc.)	<input checked="" type="checkbox"/>		<input checked="" type="checkbox"/>	<input type="checkbox"/>	<input type="checkbox"/>
2. Description of materials (Provide samples, if appropriate)	<input checked="" type="checkbox"/>		<input checked="" type="checkbox"/>	<input type="checkbox"/>	<input type="checkbox"/>
3. Color Photographs of existing conditions are required. Minimum image size 4" x 6" as printed. Maximum 2 images per page. Photos should be of each side of the house, fully show the yards, and include streetscapes.	<input checked="" type="checkbox"/>		<input checked="" type="checkbox"/>	<input type="checkbox"/>	<input type="checkbox"/>
4. Paint Schedule (if applicable)	<input type="checkbox"/>	<input checked="" type="checkbox"/>	<input type="checkbox"/>	<input type="checkbox"/>	<input checked="" type="checkbox"/>
5. Site Drawings. Required for projects that include any addition, demolition, fences, walls, or other landscape work. <ul style="list-style-type: none"> • Plot plan showing relationship of buildings, additions, sidewalks, drives, trees, property lines, etc. • Tree survey include size, species, and critical root zone for each tree over 8" diameter when measured 4' above ground level • Tree protection plan include material staging area, construction access, limits of disturbance, location of tree protection fencing • Grading plan • Dimensions shown on drawings and/or graphic scale (required) • 11"x17" or 8-1/2"x11" reductions of full-size drawings 	<input type="checkbox"/>	<input checked="" type="checkbox"/>	<input type="checkbox"/>	<input checked="" type="checkbox"/>	<input type="checkbox"/>
6. Architectural Drawings showing existing and proposed work (if applicable) <ul style="list-style-type: none"> • Plan drawings • Elevation drawings showing the façade(s). For additions, deck, and porches, include the grade. • Dimensions shown on drawings and/or graphic scale (required) • 11" x 17" or 8-1/2" x 11" reductions of full-size drawings. If reduced size is so small as to be illegible, make 11" x 17" or 8-1/2" x 11" snap shots of individual drawings from the big sheet. 	<input type="checkbox"/>	<input checked="" type="checkbox"/>	<input type="checkbox"/>	<input type="checkbox"/>	<input checked="" type="checkbox"/>
7. Stamped envelopes addressed to all property owners within 100 feet of property, on all sides of the property, as well as the property owner (required for Major Work). Use the Label Creator to determine the addresses.	<input type="checkbox"/>	<input checked="" type="checkbox"/>	<input type="checkbox"/>	<input type="checkbox"/>	<input checked="" type="checkbox"/>
8. Fee (See Development Fee Schedule)	<input checked="" type="checkbox"/>		<input type="checkbox"/>	<input checked="" type="checkbox"/>	<input type="checkbox"/>

327 East Jones St, Raleigh
Removal of Unsafe Maple Tree

This application for a certificate of appropriateness is to request approval for removal of a dangerous tree and a replacement with a similar tree. The tree in question is a maple tree approximately 25 years old which has developed a split in the trunk. The tree is located on the southeast corner of the property, on the corner of East Jones and North Bloodworth Streets (Figure 1). The tree is located between the sidewalk and the front porch, and is planted within the lot. A certified arborist, Jared Kibbe, from Bartlett Tree Experts has evaluated the tree, and provided a report (a copy is attached). He has indicated that a large stem crack has formed in the main union of the upper canopy and is travelling down the tree, and that the tree is at risk of falling onto our property, power lines, and the street. We propose to have the tree removed as soon as possible, have the stump ground out, and replace the tree with a similar tree (a maple or similar).

Photographs of the tree, its location next to the house, and adjacent power lines are provided below Figures 2-6. .

Figure 1. Map showing the approximate location of the tree as a red circle.

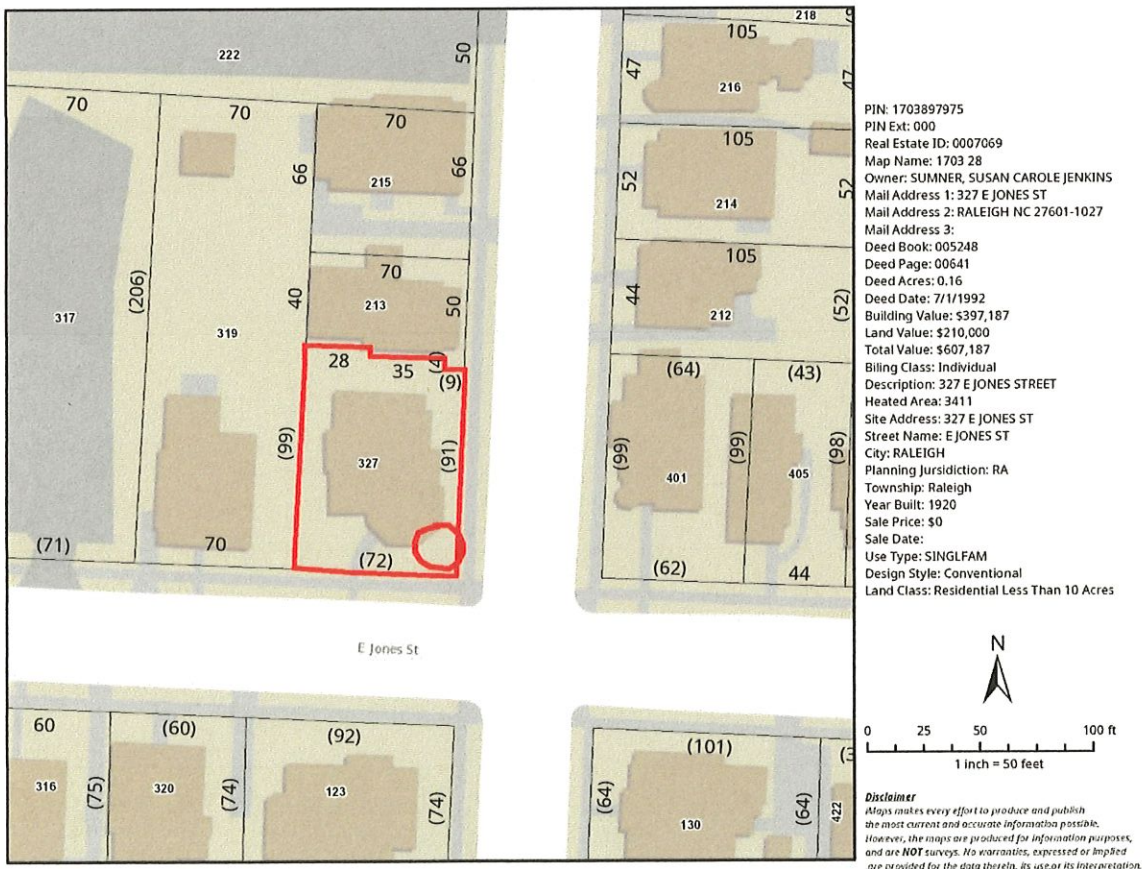



Figure 2. Crack in the trunk of the maple tree from the western side.



Figure 3. The maple tree on the south east corner of the lot, with the street sign for E Jones and N. Bloodworth streets shown for orientation.



Figure 4. View of upper branches looking east along Jones St.



Figure 5. Looking north on the corner of E Jones St.



Figure 6. Split viewed from the eastern side.



BARTLETT TREE EXPERTS

5808 Triangle Drive, Raleigh, NC 27617 Telephone 919-782-7803 Fax 919-788-9147

04/25/19

To whom it may concern:

Upon inspecting the large Maple located at 327 E Jones Street, I recommend immediate removal of this tree. A large stem crack has formed in the main union of the upper canopy and is traveling down the tree. This tree is actively failing and is at risk of falling onto the client's property, power lines, and street.

Bartlett Tree Experts has provided the client with a proposal for removal and is ready to perform this service upon approval.

Please reach out with any questions.

Thank you,

Jared Kibbe
ISA Certified Arborist #SO-7534A
Arborist Representative – Raleigh, NC

THE F.A. BARTLETT TREE EXPERT COMPANY
SCIENTIFIC TREE CARE SINCE 1907

CORPORATE OFFICE: P.O. BOX 3067, STAMFORD, CONNECTICUT 06905-0067 (203)323-1131; FAX (203) 323-1129

www.bartlett.com