

CERTIFICATE OF APPROPRIATENESS PLACARD

for Raleigh Historic Resources

723 ST MARY'S STREET

Address

Historic District

BROUGHTON HIGH SCHOOL

Historic Property

186-17-MW

Certificate Number

12-19-2017

Date of Issue

06-19-2018

Expiration Date

Project Description:

- Install 4 new light poles to match existing.

This card must be kept pasted in a location within public view until all phases of the described project are complete. The work must conform with the code of the City of Raleigh and laws of the state of North Carolina. When your project is complete, you are required to ask for a final zoning inspection in a historic district area. Telephone the RHDC office at 832-7238 and commission staff will coordinate the inspection with the Inspections Department. If you do not call for this final inspection, your Certificate of Appropriateness is null and void.

Signature

Raleigh Historic Development Commission

Pending the resolution of appeals, commencement of work is at your own risk.

Raleigh Historic Development Commission – Certificate of Appropriateness (COA) Application



**DEVELOPMENT
SERVICES
DEPARTMENT**

**Development Services
Customer Service Center**
One Exchange Plaza
1 Exchange Plaza, Suite 400
Raleigh, North Carolina 27601
Phone 919-996-2495
eFax 919-996-1831



<input type="checkbox"/> Minor Work (staff review) – 1 copy <input type="checkbox"/> Major Work (COA Committee review) – 10 copies <ul style="list-style-type: none"> <input type="checkbox"/> Additions Greater than 25% of Building Square Footage <input type="checkbox"/> New Buildings <input type="checkbox"/> Demo of Contributing Historic Resource <input type="checkbox"/> All Other <input type="checkbox"/> Post Approval Re-review of Conditions of Approval	<p style="text-align: center;">For Office Use Only</p> Transaction # <u>536908</u> File # <u>156-17-MW</u> Fee <u>0</u> Amount Paid <u>0</u> Received Date <u>11/22/17</u> Received By <u>[Signature]</u>
---	---

Property Street Address 723 St. Mary's St.

Historic District _____

Historic Property/Landmark name (if applicable) Broughton High School

Owner's Name City of Raleigh

Lot size _____ (width in feet) _____ (depth in feet)

For applications that require review by the COA Committee (Major Work), provide addressed, stamped envelopes to owners of all properties within 100 feet (i.e. both sides, in front (across the street), and behind the property) not including the width of public streets or alleys (Label Creator).

Property Address	Property Address

I understand that all applications that require review by the commission's Certificate of Appropriateness Committee must be submitted by 4:00 p.m. on the application deadline; otherwise, consideration will be delayed until the following committee meeting. An incomplete application will not be accepted.

Type or print the following:

Applicant Margaret Kline BHS PTSA President

Mailing Address 723 St. Mary's St.

City Raleigh State NC Zip Code 27605

Date 11-21-17 Daytime Phone 919-624-9888

Email Address mejkline@me.com

Applicant Signature Margaret Kline

Will you be applying for rehabilitation tax credits for this project? Yes No

Did you consult with staff prior to filing the application? Yes No

Office Use Only

Type of Work _____
456

Design Guidelines - Please cite the applicable sections of the design guidelines (www.rhdc.org).

Section/Page	Topic	Brief Description of Work (attach additional sheets as needed)
1.	Addition of Light Poles	<ul style="list-style-type: none"> • Install 4 new pole lights around the front courtyard of school. • Single head to match existing • New concrete bases to be poured for all new poles. • Poles to be powered from existing source in the area (see attached proposal)

Pitt Electric

November 21, 2017

Wake County Public School System, Broughton High School
723 Saint Mary's St.
Raleigh, NC 27605
Attention: Elizabeth Sharpe

Reference: Broughton Pole Lighting Revision 1
Via: E-mailed to esharpe@wcpss.net

Dear Elizabeth,

We appreciate the opportunity to submit a price quotation for this project. We include all work per the information provided to us. Our bid will conform to the delineation of work as set forth in this scope of work. Electrical work covered by our quotation includes furnishing of all labor, material and equipment necessary to complete our portion of the work as clarified below.

Scope of Work:

- Install (4) new pole lights around the front of school in the courtyard area. New poles to be single head, and will match existing.
- New concrete bases to be poured for all new poles.
- Poles to be powered from existing source in area, and all new lines to be trenched in ground.
- New junction boxes to be installed in ground where needed.
- Utility locating to be performed.

Clarifications:

1. No bond is included in this quotation.
2. Based on all work being performed during normal business hours.
3. The following items are specifically excluded:
 - a. Design or engineering of any type.
4. This proposal may be withdrawn if not accepted within 30 days.

Our price for this work is: Twenty-Eight Thousand One Hundred Five Dollars (\$28,105.00)

We look forward to the opportunity of working with you on this project. If you need any additional information or have any questions, please do not hesitate to call.

Sincerely,

Warren Phillips
Project Manager
Pitt Electric
Garner Branch

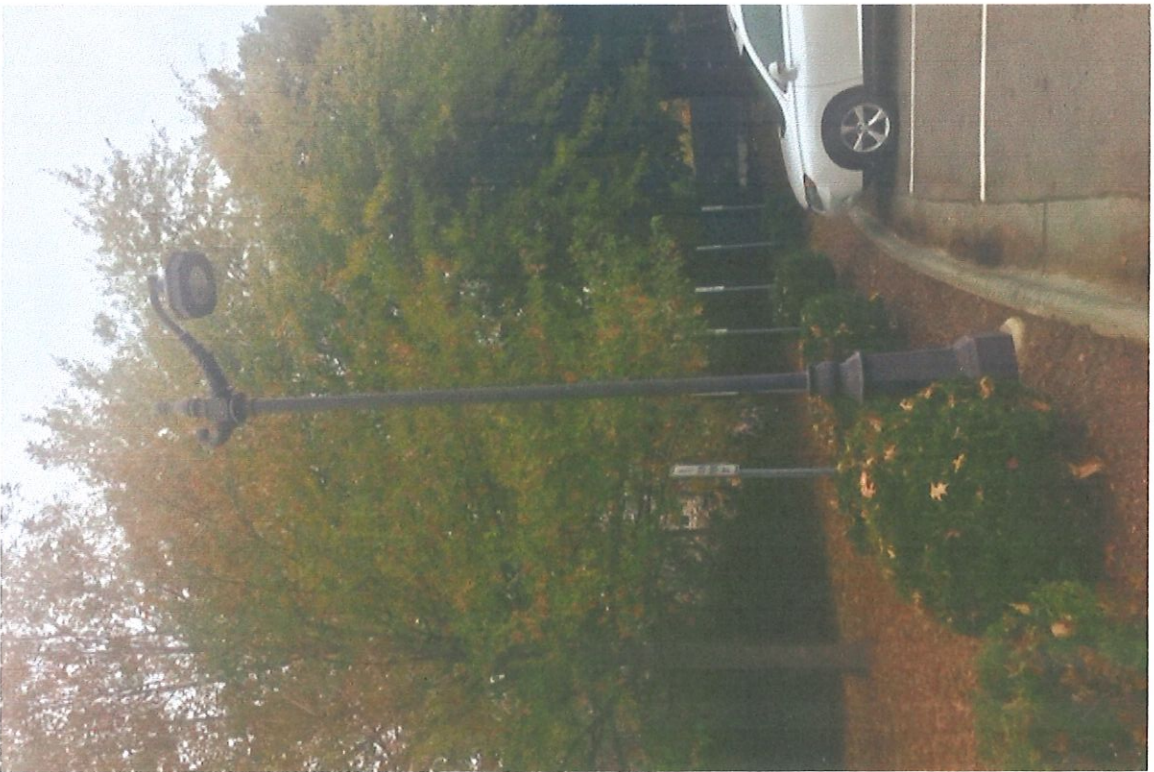

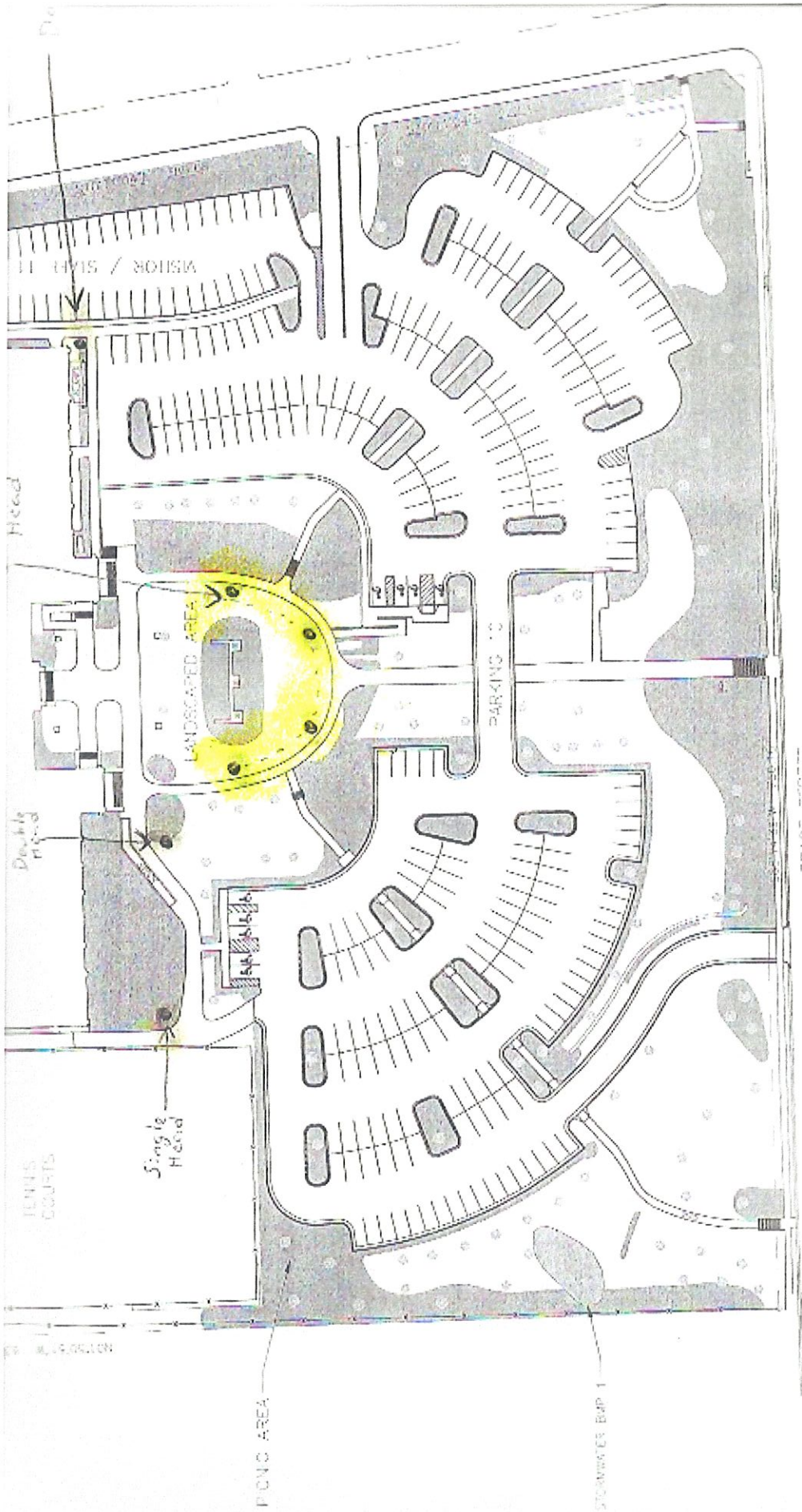

* new poles highlighted



FACILITY PLANNING
1551 Wake, Sherry Road
Raleigh, NC 27610

DWG Owner: SEPT. 22, 2003

DWG No: CAD-GRAPHICS

Checked by:

Approved by:

13	6/7/02	10469	REVIS	NEW PAVEMENT
12	5/27/02	10468	REVIS	NEW PAVEMENT
11	5/27/02	10467	REVIS	NEW PAVEMENT
10	5/27/02	10466	REVIS	NEW PAVEMENT
9	5/27/02	10465	REVIS	NEW PAVEMENT
8	5/27/02	10464	REVIS	NEW PAVEMENT
7	5/27/02	10463	REVIS	NEW PAVEMENT
6	5/27/02	10462	REVIS	NEW PAVEMENT
5	5/27/02	10461	REVIS	NEW PAVEMENT
4	5/27/02	10460	REVIS	NEW PAVEMENT
3	5/27/02	10459	REVIS	NEW PAVEMENT
2	5/27/02	10458	REVIS	NEW PAVEMENT
1	5/27/02	10457	REVIS	NEW PAVEMENT

Key Plan:

Sheet No. 1 of 13

Site Name and Address:

**BROUGHTON
HIGH
SCHOOL**

722 St. Mary's Street
Raleigh, North Carolina
27605

Lot and Sheet Numbers:
920 - 348

Scale:
1" = 80'



Date:

SITE PLAN

SP1

Sheet:
1 of 10

Number:
13

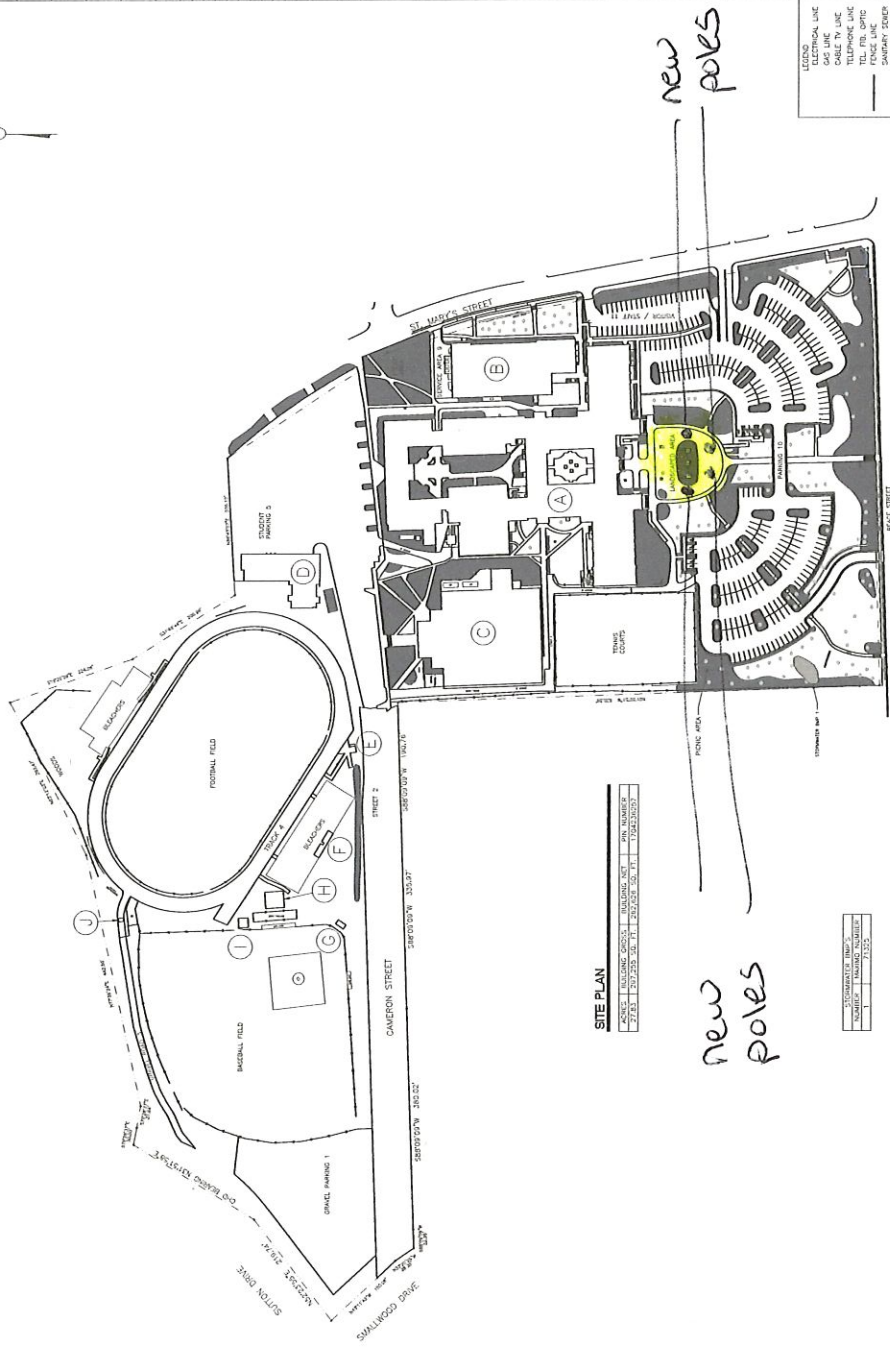

SITE PLAN

DATE	BY	NO.
09/22/03	JMS	001
05/27/02	JMS	002
05/27/02	JMS	003
05/27/02	JMS	004
05/27/02	JMS	005
05/27/02	JMS	006

DATE	BY	NO.
09/22/03	JMS	001
05/27/02	JMS	002
05/27/02	JMS	003
05/27/02	JMS	004
05/27/02	JMS	005
05/27/02	JMS	006