



CERTIFICATE OF APPROPRIATENESS PLACARD

for Raleigh Historic Resources

708 ST MARY'S STREET

Address

GLENWOOD-BROOKLYN

Historic District

Historic Property

113-17-MW

Certificate Number

06-29-2017

Date of Issue

12-29-2017

Expiration Date

Project Description:

- Alter planting bed: install shrubs and ground cover plants

This card must be kept pasted in a location within public view until all phases of the described project are complete. The work must conform with the code of the City of Raleigh and laws of the state of North Carolina. When your project is complete, you are required to ask for a final zoning inspection in a historic district area. Telephone the RHDC office at 832-7238 and commission staff will coordinate the inspection with the Inspections Department. If you do not call for this final inspection, your Certificate of Appropriateness is null and void.

Signature, _____

Raleigh Historic Development Commission

Pending the resolution of appeals, commencement of work is at your own risk.

Raleigh Historic Development Commission – Certificate of Appropriateness (COA) Application



**DEVELOPMENT
SERVICES
DEPARTMENT**

Development Services
Customer Service Center
One Exchange Plaza
1 Exchange Plaza, Suite 400
Raleigh, North Carolina 27601
Phone 919-996-2495
eFax 919-996-1831



<input checked="" type="checkbox"/> Minor Work (staff review) – 1 copy <input type="checkbox"/> Major Work (COA Committee review) – 10 copies <input type="checkbox"/> Additions Greater than 25% of Building Square Footage <input type="checkbox"/> New Buildings <input type="checkbox"/> Demo of Contributing Historic Resource <input type="checkbox"/> All Other <input type="checkbox"/> Post Approval Re-review of Conditions of Approval	For Office Use Only Transaction # <u>518291</u> File # <u>113-17-MW</u> Fee <u>2900</u> Amount Paid <u>2900</u> Received Date <u>6-16-17</u> Received By <u>[Signature]</u>
--	--

Property Street Address 708 Saint Mary's Street, Raleigh, NC 27605

Historic District Glenwood Brooklyn

Historic Property/Landmark name (if applicable) _____

Owner's Name Carnard Properties, LLC

Lot size 0.19 acres (width in feet) ^(area of work) 17' + (6.5') (depth in feet) 12' + (10') – see plan

For applications that require review by the COA Committee (Major Work), provide addressed, stamped envelopes to owners of all properties within 100 feet (i.e. both sides, in front (across the street), and behind the property) not including the width of public streets or alleys ([Label Creator](#)).

Property Address	Property Address

Minor Work Approval (office use only)

Upon being signed and dated below by the Planning Director or designee, this application becomes the Minor Work Certificate of Appropriateness. It is valid until 12/29/17. Please post the enclosed placard form of the certificate as indicated at the bottom of the card. Issuance of a Minor Work Certificate shall not relieve the applicant, contractor, tenant, or property owner from obtaining any other permit required by City Code or any law. Minor Works are subject to an appeals period of 30 days from the date of approval.

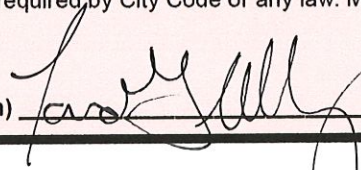
Signature (City of Raleigh)  Date 6/29/17

	TO BE COMPLETED BY APPLICANT		TO BE COMPLETED BY CITY STAFF		
	YES	N/A	YES	NO	N/A
<p>Attach 8-1/2" x 11" or 11" x 17" sheets with written descriptions and drawings, photographs, and other graphic information necessary to completely describe the project. Use the checklist below to be sure your application is complete.</p> <p>Minor Work (staff review) – 1 copy</p> <p>Major Work (COA Committee review) – 10 copies</p>					
1. Written description. Describe clearly and in detail the nature of your project. Include exact dimensions for materials to be used (e.g. width of siding, window trim, etc.)	<input checked="" type="checkbox"/>				
2. Description of materials (Provide samples, if appropriate)	<input checked="" type="checkbox"/>				
3. Photographs of existing conditions are required. Minimum image size 4" x 6" as printed. Maximum 2 images per page.	<input checked="" type="checkbox"/>				
4. Paint Schedule (if applicable)	<input type="checkbox"/>	<input checked="" type="checkbox"/>			
5. Plot plan (if applicable). A plot plan showing relationship of buildings, additions, sidewalks, drives, trees, property lines, etc., must be provided if your project includes any addition, demolition, fences/walls, or other landscape work. Show accurate measurements. You may also use a copy of the survey you received when you bought your property. Revise the copy as needed to show existing conditions and your proposed work.	<input type="checkbox"/>	<input checked="" type="checkbox"/>			
6. Drawings showing existing and proposed work <ul style="list-style-type: none"> <input type="checkbox"/> Plan drawings <input type="checkbox"/> Elevation drawings showing the façade(s) <input type="checkbox"/> Dimensions shown on drawings and/or graphic scale (required) <input type="checkbox"/> 11" x 17" or 8-1/2" x 11" reductions of full-size drawings. If reduced size is so small as to be illegible, make 11" x 17" or 8-1/2" x 11" snap shots of individual drawings from the big sheet. 	<input checked="" type="checkbox"/>	<input type="checkbox"/>			
7. Stamped envelopes addressed to all property owners within 100 feet of property not counting the width of public streets and alleys (required for Major Work). Use the Label Creator to determine the addresses.	<input type="checkbox"/>	<input checked="" type="checkbox"/>			
8. Fee (See Development Fee Schedule)	<input checked="" type="checkbox"/>				

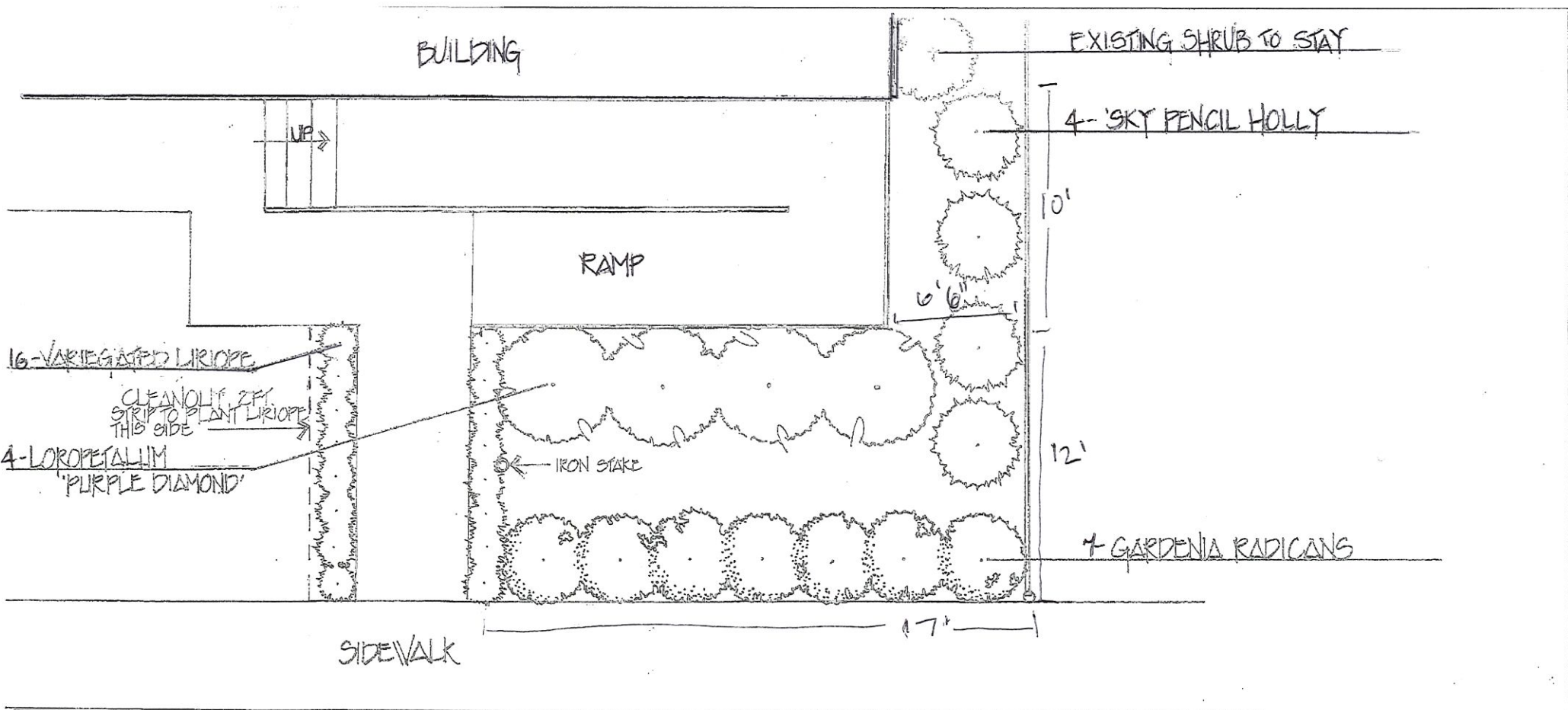

REVISED PLAN LOGAN'S <i>One stop garden shop</i>		Landscape Plan For: MAPLE ENGINEERING 708 ST. MARY'S ST. RALEIGH, NC 27605 919-341-4247
707 Semart Drive, Raleigh, NC 27604 919-828-5337 www.logantrd.com		 North
Designer: R	Date: 5-23-2017	
Scale: $\frac{1}{4}'' = 1'-0''$		

Maple Engineering Plant Pictures

Loropetalum 'Purple Diamond'



This one grows 4 to 5 feet tall and wide. Showy pink flowers appear in spring and sometimes summer. Deep, rich purple foliage holds its color all season. Evergreen.

Gardenia 'Kleim's Hardy'



The hardest of the Gardenias in a versatile, dwarf size. Great in containers, raised beds and in the foreground of borders. Striking aroma! Flowers are star-like with five petals. Grows 2 to 3 feet tall and wide. Evergreen.

Variegated Liriope



Great as an accent to other plants. Very versatile and grows as a clump-forming groundcover or edging around perennial or shrub borders. Evergreen. 15 inches tall and wide.

Holly 'Sky Pencil'



Dark green foliage stays neat year-round, often sporting small purple berries in fall. Outstanding evergreen for vertical accent, entryways or privacy screening. Grows 6-8 feet tall, 2-3 wide. Evergreen.



708 St. Marys Street, Raleigh NC 27605
existing conditions



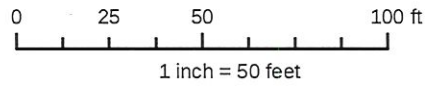
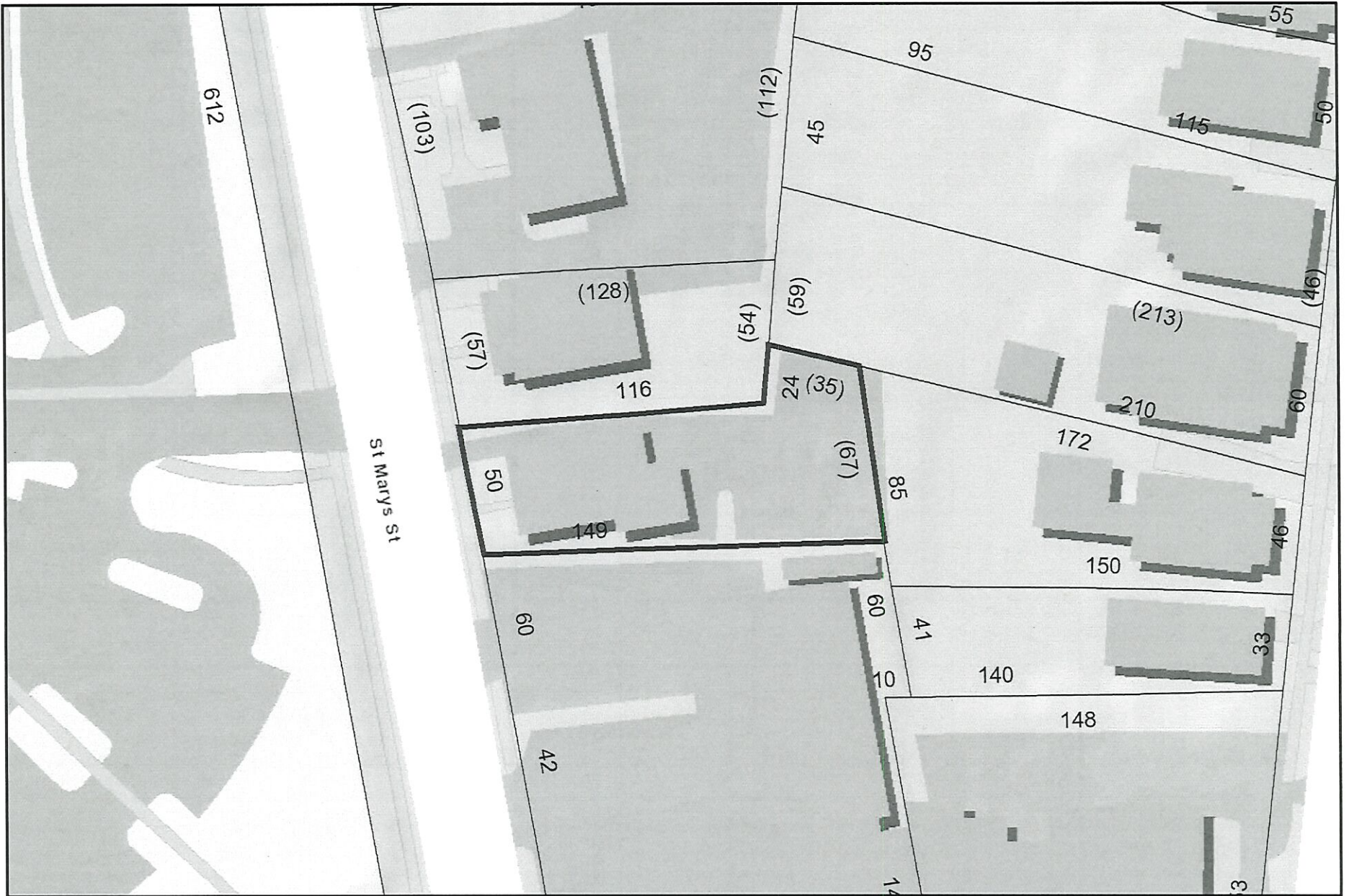

Disclaimer
 IMaps makes every effort to produce and publish the most current and accurate information possible. However, the maps are produced for information purposes, and are NOT surveys. No warranties, expressed or implied, are provided for the data therein, its use, or its interpretation.

Google Maps 706 St Marys St



Image capture: Feb 2016 © 2017 Google

Raleigh, North Carolina

Street View - Feb 2016

Google Maps 706 St Marys St



Image capture: Apr 2017 ©2017 Google

Raleigh, North Carolina

Street View - Apr 2017

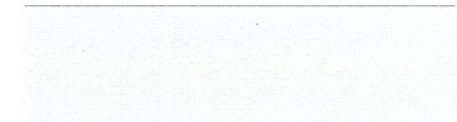



708 St Marys St



Image capture: Feb 2016 © 2017 Google

Raleigh, North Carolina

Street View - Feb 2016

Google Maps 708 St Marys St



Image capture: Apr 2017 © 2017 Google

Raleigh, North Carolina

Street View - Apr 2017

