

CERTIFICATE OF APPROPRIATENESS PLACARD

for Raleigh Historic Resources

731 S BOYLAN AVENUE

Address

BOYLAN HEIGHTS

Historic District

Historic Property

090-14-MW

Certificate Number

7/8/2014

Date of Issue

1/8/2015

Expiration Date

Project Description:

- Remove and replace front and side doors.

OK to PERMIT

This card must be kept pasted in a location within public view until all phases of the described project are complete. The work must conform with the code of the City of Raleigh and laws of the state of North Carolina. When your project is complete, you are required to ask for a final zoning inspection in a historic district area. Telephone the RHDC office at 832-7238 and commission staff will coordinate the inspection with the Inspections Department. If you do not call for this final inspection, your Certificate of Appropriateness is null and void.

Signature, _____
Raleigh Historic Development Commission



Planning & Development

Development Services
 Customer Service Center
 One Exchange Plaza
 1 Exchange Plaza, Suite 400
 Raleigh, North Carolina 27601
 Phone 919-996-2495
 eFax 919-996-1831

Raleigh Historic Development Commission – Certificate of Appropriateness (COA) Application



- Minor Work (staff review) – 1 copy
- Major Work (COA Committee review) – 13 copies
 - Most Major Work Applications
 - Additions Greater than 25% of Building Square Footage
 - New Buildings
 - Demo of Contributing Historic Resource
 - Post Approval Re-review of Conditions of Approval

For Office Use Only

Transaction # 401261
 File # 070-14-MW
 Fee \$28
 Amt Paid \$40 → refunded \$12
 Check # \$ 12/5
 Rec'd Date 7/1/14
 Rec'd By J. Hurley
App Complete 7/7/14

• If completing by hand, please use **BLACK INK**. Do not use blue, red, any other color, or pencil as these do not photocopy.

Property Street Address 731 S Boylan Ave

Historic District Boylan Heights

Historic Property/Landmark name (if applicable) n/a

Owner's Name Victor & Angelika Harabin

Lot size n/a

(width in feet)

(depth in feet)

For applications that require review by the COA Committee (Major Work), provide addressed, stamped envelopes to owners of all properties within 100 feet (i.e. both sides, in front (across the street), and behind the property) not including the width of public streets or alleys:

Property Address	Property Address

I understand that all applications that require review by the commission's Certificate of Appropriateness Committee must be submitted by 4:00 p.m. on the application deadline; otherwise, consideration will be delayed until the following committee meeting. An incomplete application will not be accepted.

Type or print the following:

Applicant **Victor Harabin**

Mailing Address **731 S Boylan Ave**

City **Raleigh** State **NC** Zip Code **27603**

Date **June 19, 2014** Daytime Phone **919-810-0805**

Email Address **vharabin@nc.rr.com**

Signature of Applicant 

Minor Work Approval (office use only)

Upon being signed and dated below by the Planning Director or designee, this application becomes the Minor Work Certificate of Appropriateness. It is valid until 1/8/15. Please post the enclosed placard form of the certificate as indicated at the bottom of the card. Issuance of a Minor Work Certificate shall not relieve the applicant, contractor, tenant, or property owner from obtaining any other permit required by City Code or any law. Minor work projects not approved by staff will be forwarded to the Certificate of Appropriateness Committee for review at the next scheduled meeting.

Signature  Date 7/8/14
 as amended 

Project Categories (check all that apply):

- Exterior Alteration
- Addition
- New Construction
- Demolition

Will you be applying for state or federal rehabilitation tax credits for this project?

- Yes
- No

(Office Use Only)

Type of Work _____

29

Design Guidelines Please cite the applicable sections of the design guidelines (www.rhdc.org).

Section/Page	Topic	Brief Description of Work
Sec 3 pg 39-41	Windows/Doors	We want to replace our front door & rear side deck exterior doors due to warping and breach of seal in double paned windows.
		We will preserve the character of the house design by replacing these faulty doors with craftsman styled doors.

	TO BE COMPLETED BY APPLICANT		TO BE COMPLETED BY CITY STAFF		
	YES	N/A	YES	NO	N/A
<p>Attach 8-1/2 " x 11" sheets with written descriptions and drawings, photographs, and other graphic information necessary to completely describe the project. Use the checklist below to be sure your application is complete.</p> <p>Minor Work (staff review) – 1 copy</p> <p>Major Work (COA Committee review) – 13 copies</p>					
1. Written description. Describe clearly and in detail the nature of your project. Include exact dimensions for materials to be used (e.g. width of siding, window trim, etc.)	<input checked="" type="checkbox"/>		✓		
2. Description of materials (Provide samples, if appropriate)	<input checked="" type="checkbox"/>		✓		
3. Photographs of existing conditions are required.	<input checked="" type="checkbox"/>			✓	
4. Paint Schedule (if applicable)	<input type="checkbox"/>	<input checked="" type="checkbox"/>			✓
5. Plot plan (if applicable). A plot plan showing relationship of buildings, additions, sidewalks, drives, trees, property lines, etc., must be provided if your project includes any addition, demolition, fences/walls, or other landscape work. Show accurate measurements. You may also use a copy of the survey you received when you bought your property. Revise the copy as needed to show existing conditions and your proposed work.	<input type="checkbox"/>	<input checked="" type="checkbox"/>			✓
6. Drawings showing proposed work <ul style="list-style-type: none"> <input type="checkbox"/> Plan drawings <input type="checkbox"/> Elevation drawings showing the new façade(s). <input type="checkbox"/> Dimensions shown on drawings and/or graphic scale. <input type="checkbox"/> 8-1/2" x 11" reductions of full-size drawings. If reduced size is so small as to be illegible, make 8-1/2" x 11" snap shots of individual drawings on the big sheet. 	<input checked="" type="checkbox"/>	<input type="checkbox"/>	✓		
7. Stamped envelopes addressed to all property owners within 100 feet of property not counting the width of public streets and alleys. (Required for Major Work)	<input type="checkbox"/>	<input checked="" type="checkbox"/>			✓
8. Fee (See Development Fee Schedule)	<input checked="" type="checkbox"/>		✓		

731 S Boylan Ave

Raleigh NC 27603

June 19, 2014

Dear Raleigh Historic District Commission:

Enclosed is my application for Certificate of Appropriateness to replace 2 exterior doors on my home located at 731 S Boylan Ave. I have enclosed the application, a check for \$40.00, information on the replacement doors as well as a description of why this work needs to be done.

I hope this information is sufficient for your review. Please let me know if you need anything else.

Sincerely,

A handwritten signature in blue ink, appearing to read "Victor Harabin", with a stylized flourish at the end.

Victor Harabin

Our home was built and completed in May 2005 as a new construction compliant with all historic standards applicable for Boylan Heights. Unfortunately 2 of our exterior doors have had problems which cannot be repaired. Our front door facing Boylan Ave is warped at the top which allows both cold & hot air to enter the home—it cannot be unwarped. We also have a deck door facing out toward Dorthea Drive which is a sealed double paned glass door which has had a breach in the seal and now humidity is seen between the 2 glass panels and is unsightly—I don't think photography can show either of these problems.

We want to maintain the character of the house and use a more durable, energy efficient wood molded fiberglass doors to replace both these doors. My wife was dead set against the fiberglass until I took her in to the showroom at Stock lumber and she saw for herself how nice the doors look. They are indistinguishable from a real wood door unless you cut into them or knock on the door. The molde for the fiberglass is based on a real wood door. I am enclosing the specs for each door we would like to replace. In the front (Boylan Ave) we would change the current clear glass to a decorative stained glass door with a mahogany stain for the wood surrounding the glass. For the deck door, we want to decrease the amount of glass (because it is southern facing) to 2/3rds of the door length. Also, we would maintain the current red color of the wood surrounding the glass.

I hope this information is adequate.

Respectfully,



Victor Harabin



Application Amended
per 7/2/14 email
RGT

Amendment

Tully, Tania

From: Victor Harabin <vharabin@nc.rr.com>
Sent: Wednesday, July 02, 2014 7:43 PM
To: Tully, Tania
Subject: Re: COA Application for 731 S Boylan Avenue

Ok, fair enough. I will find a wood door for the front & provide more info on the door for the back. It opens to a second level deck and is only partially visible from Dorthea Dr. It's the one that seems to get the weather and sun the worst. I'll also send some pictures of the current doors. Thanks

On Jul 2, 2014, at 3:22 PM, "Tully, Tania" <Tania.Tully@raleighnc.gov> wrote:

Yes. I do need better info on the proposed door though.

Tania Georgiou Tully, Preservation Planner
Long Range Planning Division
Raleigh Department of City Planning
919.996.2674
919.516.2684 (fax)
tania.tully@raleighnc.gov

COA process information is available [here](#).

From: Victor Harabin [<mailto:vharabin@nc.rr.com>]
Sent: Wednesday, July 02, 2014 3:15 PM
To: Tully, Tania
Subject: Re: COA Application for 731 S Boylan Avenue

Ms Tully--I'm going to re look at the wood options for replacement. Is it possible to keep the rear door a smooth fiberglass without requesting a major change as long as the front is wood?

On Jul 2, 2014, at 2:44 PM, "Tully, Tania" <Tania.Tully@raleighnc.gov> wrote:

Mr. Harabin -

One change to my previous email. The smooth faced fiberglass is approvable on the rear doors, but has not yet been approved for a primary door. See page 11 on the attached.

Best,
Tania

Tania Georgiou Tully, Preservation Planner
Long Range Planning Division
Raleigh Department of City Planning
919.996.2674
919.516.2684 (fax)
tania.tully@raleighnc.gov

COA process information is available [here](#).

Per CoA
145-12-CA
• only detached
new construction
• secondary doors
bt facing dominant
street
GT

Tully, Tania

From: Tully, Tania
Sent: Wednesday, July 02, 2014 2:30 PM
To: 'vharabin@nc.rr.com'
Subject: COA Application for 731 S Boylan Avenue

Mr. Harabin –

Thank you for submitting the COA application for replacing the doors on your house with fiberglass doors. This is not something that can be approved at the staff level. The Raleigh Historic Development Commission (RHDC) has not yet approved the use of non-wood doors, even on detached new construction. Because of this, the application will be forwarded to the COA Committee for review. The next available meeting date is August 4.

In order to complete the application and be placed on the agenda, please provide the following by the application deadline of July 16, 4 pm.

- Application fee of \$116 (\$144 Major Work fee - \$28 already paid). This may be made via telephone (919-996-2495) or in person (Drop off at the **4th floor** of One Exchange Plaza to my attention) referencing transaction number 401261.
- Stamped envelopes addressed to the property owners within 100 feet of your property. This app will generate the addresses help create labels: <http://maps.raleighnc.gov/PlanMailList/> (Drop off at the **3rd floor** of One Exchange Plaza to my attention)
- Current photographs of the house and the doors to be replaced.
- Additional information for the proposed new doors. This could include some of the following:
 - Better illustrations of the proposed doors;
 - Manufacturer information that answers these questions:
 - What is the surface texture? The commission has generally not approved faux grain textures.
 - Can it be painted?
 - How is the glass held into the door?
 - How is it constructed?

Looking at the specs you provided in the application it appears that the products are Jeld-Wen Smooth-Pro and Design-Pro. Based on past decisions, I believe a case can be made that the Smooth-Pro door meets the [Design Guidelines](#). The Design-Pro may be problematic due to the woodgrain fiberglass facing. Bringing a sample to the meeting may be to your advantage.

A The other option is to switch to wood doors that I can approve at the staff level. — *selected*

Please let me know if you have any questions and how you wish to proceed.

Best,
Tania

Tania Georgiou Tully, Preservation Planner
Long Range Planning Division
Raleigh Department of City Planning
919.996.2674
919.516.2684 (fax)
tania.tully@raleighnc.gov

Tully, Tania

From: vharabin@nc.rr.com
Sent: Monday, July 07, 2014 9:29 AM
To: Tully, Tania
Subject: Re: COA Application for 731 S Boylan Avenue
Attachments: Front door pic.jpg; Rear door Dorthea Dr view.jpg; Rear door side view.jpg

Follow Up Flag: Follow up
Flag Status: Flagged

Here's the pictures of the current doors.

From: [Tully, Tania](#)
Sent: Wednesday, July 02, 2014 3:22 PM
To: [Victor Harabin](#)
Subject: RE: COA Application for 731 S Boylan Avenue

Yes. I do need better info on the proposed door though.

Tania Georgiou Tully, Preservation Planner
Long Range Planning Division
Raleigh Department of City Planning
919.996.2674
919.516.2684 (fax)
tania.tully@raleighnc.gov

COA process information is available [here](#).

From: Victor Harabin [mailto:vharabin@nc.rr.com]
Sent: Wednesday, July 02, 2014 3:15 PM
To: Tully, Tania
Subject: Re: COA Application for 731 S Boylan Avenue

Ms Tully--I'm going to re look at the wood options for replacement. Is it possible to keep the rear door a smooth fiberglass without requesting a major change as long as the front is wood?

On Jul 2, 2014, at 2:44 PM, "Tully, Tania" <Tania.Tully@raleighnc.gov> wrote:

Mr. Harabin –

One change to my previous email. The smooth faced fiberglass is approvable on the rear doors, but has not yet been approved for a primary door. See page 11 on the attached.

Best,
Tania

Tania Georgiou Tully, Preservation Planner
Long Range Planning Division
Raleigh Department of City Planning
919.996.2674



Rear door side view



Front door pic



Rear door Dorthea Dr view

Tully, Tania

From: vharabin@nc.rr.com
Sent: Monday, July 07, 2014 9:28 AM
To: Tully, Tania
Subject: Re: COA Application for 731 S Boylan Avenue
Attachments: Front door details.pdf; Front door picture of proposed.pdf; Rear deck door details proposed.pdf; Rear deck door proposed.pdf

Follow Up Flag: Follow up
Flag Status: Flagged

Tania—I've selected a new Oak front door and have attached info for it (both specs & a picture) as well as the rear deck door (which is smooth fiberglass). I will also send another email with pictures of the current doors (I don't want to load too many files). Thanks, Victor

From: [Tully, Tania](#)
Sent: Wednesday, July 02, 2014 3:22 PM
To: [Victor Harabin](#)
Subject: RE: COA Application for 731 S Boylan Avenue

Yes. I do need better info on the proposed door though.

Tania Georgiou Tully, Preservation Planner
Long Range Planning Division
Raleigh Department of City Planning
919.996.2674
919.516.2684 (fax)
tania.tully@raleighnc.gov

COA process information is available [here](#).

From: Victor Harabin [mailto:vharabin@nc.rr.com]
Sent: Wednesday, July 02, 2014 3:15 PM
To: Tully, Tania
Subject: Re: COA Application for 731 S Boylan Avenue

Ms Tully--I'm going to re look at the wood options for replacement. Is it possible to keep the rear door a smooth fiberglass without requesting a major change as long as the front is wood?

On Jul 2, 2014, at 2:44 PM, "Tully, Tania" <Tania.Tully@raleighnc.gov> wrote:

Mr. Harabin –

One change to my previous email. The smooth faced fiberglass is approvable on the rear doors, but has not yet been approved for a primary door. See page 11 on the attached.

Best,
Tania

Tania Georgiou Tully, Preservation Planner



Customer Information

Name: VICTOR AND ANGELIKA HARABIN
Address: 731 SO. BOYLIN RALEIGH, NC 27603
Home Phone: 9198100805
Work Phone:

Store Information

CARY
2031 WALNUT STREET
CARY, NC 27518
Store Number: 3615
Customer Agreement #: 313502
Associate: BRUCE

Product # | Product Description | Qty | Unit Price | Total Price

100-1 *** Product *** 1 Was: \$1,448.00 \$1,448.00
Premium Wood Slab Only Right Inswing 36 x 80 Now: \$1,230.80 \$1,230.80



*** Dimensions ***

Call Width = 36"
Call Height = 80"
Frame Width = 36
Frame Height = 80
*** Machining ***
Boring = None
Mortise = Standard 3 Hinge
*** SKU ***

SKU = 780810
Lead Time = 28 Days
Vendor Number = 60072836
Customer Service = (800) 617-8586
Catalog Date = 6/13/2014

*** Re-Order ***
Is this a re-order = No
*** Hardware ***

Hinge Finish = Satin Nickel
*** EDS ***

Collection = Deco Glass
Glass Layout = 3/4 Lite
Species = Oak
Glass Name = Diamondback
Grill/Caming Option = Patina

*** Unit Type ***
Unit Type = Complete Unit
Handing = Right Inswing

*** Finishing ***
Exterior Door Slab Finishing = Oak - Harvest
*** Door ***

Thickness = 1-3/4"
Core = Engineered Wood Core

Save \$217.20 (15%) until 7/9/2014
* S/O STEVES AND SONS-780810
Promotion until 7/9/2014

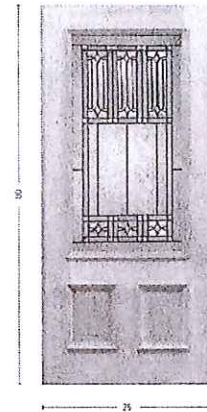

Handwritten note: 313504 Front Slab

Handwritten note: Front Door

DIAMONDBACK COLLECTION

DIAMONDBACK COLECCIÓN

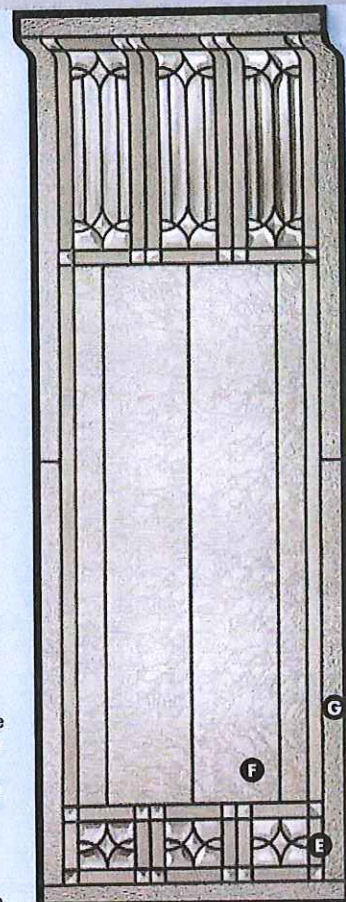
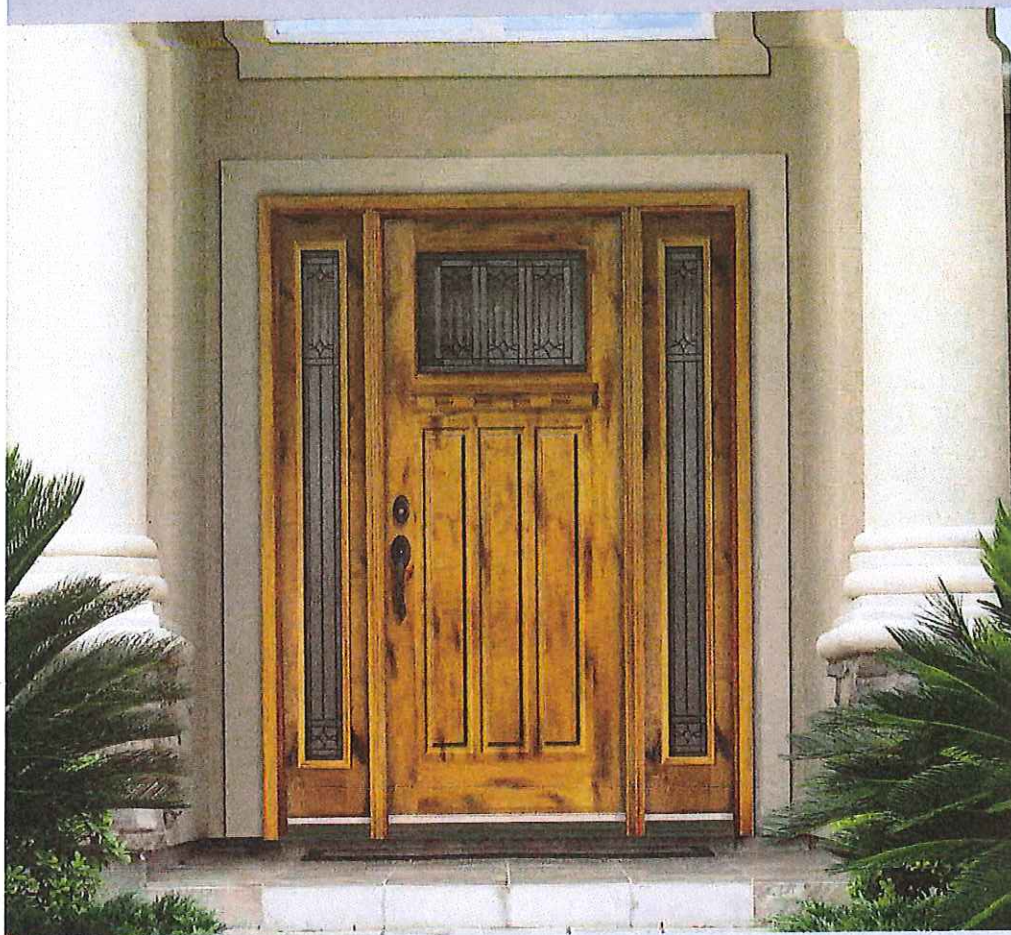

- A - Clear Baroque
- B - Clear Beveled
- C - Glue Chip
- D - Double Ripple
- E - Reed
- F - Delta Frost
- G - Granite
- H - Hammered
- I - Gray Baroque
- J - Rain

Diamondback
 Privacy Rating: **8**
 Patina Caming

PRIVACY RATINGS

Valoraciones de privacidad

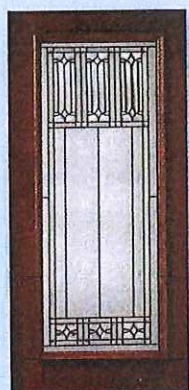
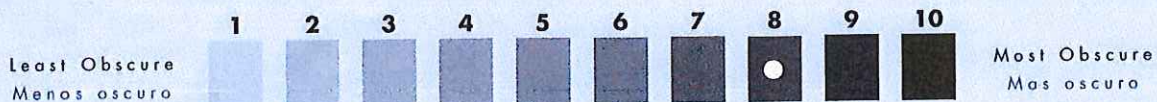

Full Lite
 Completo Lite



3/4 Lite
 3/4 Lite



3/4 Arch
 3/4 Arco



3/4 Sidelite
 3/4 Sidelite



Full Sidelite
 Completo Sidelite

Make a statement with your wood door.

A wood door is more than a door — it's a statement from warm to bold to elegant, creating a strong impression that carries on into the room and throughout your home.

Steves & Sons builds doors in a wide selection of styles, so it's easy to choose affordable exterior doors that achieve the look you want.

Founded in 1866, Steves & Sons commitment to quality continues. For superior craftsmanship and beautiful doors that will compliment your home's décor, trust your style to Steves & Sons.

SELECTING YOUR DOOR TYPE

Select Your Configuration

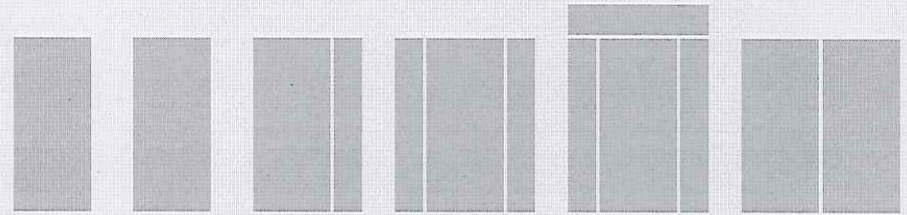

Single Door without Frame Single Door with Frame Single Door with Frame & Sidelite Single Door with Frame & 2 Sidelite Single Door with Frame & 2 Sidelite Door Door with Frame

Select Your Style



3/4 Oval 3/4 Arch Full Lite 2 Panel 9 Lite Top Lite

Select Your Species

Unfinished Mahogany

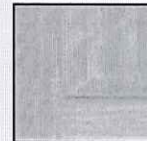

Unfinished Oak

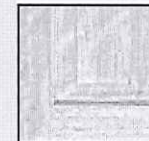

Unfinished Knotty Alder



Not all styles available in all wood species



Customer Information

Name: VICTOR AND ANGELIKA HARABIN
Address: 731 SO. BOYLIN RALEIGH, NC 27603
Home Phone: 9198100805
Work Phone:

Store Information

CARY
2031 WALNUT STREET
CARY, NC 27518
Store Number: 3615
Customer Agreement #: 313502
Associate: BRUCE

Table with columns: Product #, Product Description, Qty, Unit Price, Total Price

100-1



Entry Fiberglass Doors Slab Only Slab Only Right 31.75 x 79

1

Was: \$826.04 \$826.04
Now: \$702.11 \$702.11

Call Width = 32
Call Height = 80
Include Lockset = No
Kickplate Installed = 32" Door - 6" x 30"
Kickplate Finish = Oil Rubbed Bronze
Door Bore = Double Bore
Bore Backset = 2 3/8"
Lockset Bore Position = 44"
Dead Bolt Bore Position = 5 1/2"
Bore Diameter = 2 1/8"
Hinge Prep = None
Manufacturer = JELD-WEN, Pottsville (UV)
Customer Service = 1.800.246.9131
Catalog Version Date = 06/26/2014
Room Location = Foyer/Entry
Reorder = No

Save \$123.90 (15%) until 7/9/2014
* S/O JELD-WEN DOOR
SYSTEMS-743573 Promotion until
7/9/2014

Door Skin = Smooth-Pro
Door Type = Doors with Inserts
Door Thickness = 1 3/4"
Door Style = 1-Panel 3/4 Lite
Door Cut Out = None
Unit Type = Slab Only
Operation / Venting = Right
Swing Option = Right Inswing
Unit Spec = All Products
Building Code = Non-Certified
Energy Star Needed = Yes
Overhang Flyer = Yes
Door Finish Type = Painted
Door Finish - Exterior Side = Mesa Red
Door Finish - Interior Side = Brilliant White
Door Glass Insert Size & Shape = 22 x 48 Rectangle
Door Glass Insert Option = Clear / Privacy Grille
Designs
Door Glass Type = Standard Glass
Door Glass Design Options = 1-Lite
Door Glass Caming = None
Door Glazing / Clear or Privacy Type = Insulated Low-E
Clear
Door Glass Privacy Rating = 1
Door Glass Grille Type / Color & Profile = None
Door Order Method = Store Delivery

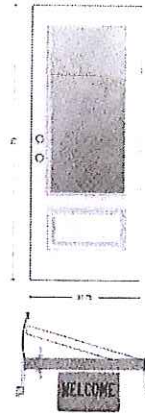

Rear Door

SMOOTH FIBERGLASS DOOR DESIGNS

Diseños de las puertas de fibra de vidrio lisas



Flush
2'8" x 6'8"
2'10" x 6'8"
3'0" x 6'8"



3-Panel
3'0" x 6'8"



4-Panel
3'0" x 6'8"



6-Panel
2'6" x 6'8"
2'8" x 6'8"
2'10" x 6'8"
3'0" x 6'8"



8-Panel
3'0" x 6'8"



Center Arch
3'0" x 6'8"



Fan Lite
2'8" x 3'0"
3'0" x 6'8"



Camber Top
2'8" x 3'0"
3'0" x 6'8"



3-Panel
with 3/4 Oval
3'0" x 6'8"



Twin 1/2 Lite
2'8" x 6'8"
2'10" x 6'8"
3'0" x 6'8"

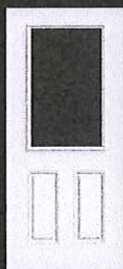

1/2 Lite
2'6" x 6'8"
2'8" x 6'8"
2'10" x 6'8"
3'0" x 6'8"



3/4 Lite
1-Panel
3'0" x 6'8"



3/4 Lite
2'8" x 6'8"
3'0" x 6'8"
Shown with
2-1/2" lock rail
and reduced
top rail of 4-1/8"



Full Oval
2'8" x 6'8"
2'10" x 6'8"
3'0" x 6'8"

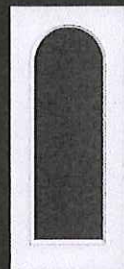

Full Lite
Round Top
2'8" x 6'8"
2'10" x 6'8"
3'0" x 6'8"



Full Lite
2'6" x 6'8"
2'8" x 6'8"
2'10" x 6'8"
3'0" x 6'8"

Fourth door in second row is proposed design only



3/4 Lite
1-Panel
3'0" x 6'8"



3/4 Lite SL
1'0" x 6'8"
1'2" x 6'8"
Bottom
panel is
10-1/2" tall

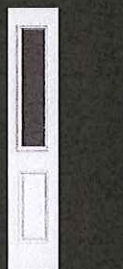

1/2 Lite SL
0'10" x
6'8"*
1'0" x 6'8"
1'2" x 6'8"



3/4 Lite SL
1'0" x 6'8"
1'2" x 6'8"
Bottom
panel is
16-1/2" tall



Full Lite SL
0'10" x 6'8"*
1'0" x 6'8"
1'2" x 6'8"

*10" sidelights accommodate 7" glass inserts only
All doors shown with clear glass, unless otherwise
annotated.

Las vidrieras de 10" solo pueden contener inserciones
de vidrio de 7" Todas las puertas se muestran con vidrio
transparente, a menos que se indique otra cosa.



8'0" Flush
3'0" x 8'0"



8'0" 6-Panel
3'0" x 8'0"



8'0" Full Lite
2'6" x 8'0"
3'0" x 8'0"



8'0" Full Lite
SL
1'0" x 8'0"
1'2" x 8'0"

VICTOR HARABIN
731 SO. BOYLIN
RALEIGH, NC 27603
9198100805

CARY
2031 WALNUT STREET
CARY, NC 27518

3615
311128
BRUCE

VOID

100-1

JELD-WEN
Entry Doors

Entry Fiberglass Doors Slab Only Slab Only Right 35.75 x 79	1	\$1,000.79	\$1,000.79
--	---	------------	------------

Call Width = 36
 Call Height = 80
 Include Lockset = No
 Kickplate Installed = None (Standard)
 Door Bore = Double Bore
 Bore Backset = 2 3/8"
 Lockset Bore Position = 44"
 Dead Bolt Bore Position = 5 1/2"
 Bore Diameter = 2 1/8"
 Hinge Prep = 3-Hinge Prep
 Hinges included = Yes
 Hinge Type = Ball Bearing w/Safety Stud
 Hinge Finish = Satin Nickel
 Hinge Size = 4" x 4-1/4"
 Hinge Radius = 5/8" Radius / Square
 First Hinge Position = 6 3/4"
 Second Hinge Position = 36"
 Third Hinge Position = 65 1/4"
 Manufacturer = JELD-WEN, Pottsville (UV)
 Customer Service = 1.800.246.9131
 Catalog Version Date = 05/06/2014
 Room Location = Foyer/Entry
 Reorder = No
 Door Skin = Design-Pro Mahogany
 Door Type = Doors with Inserts
 Door Thickness = 1 3/4"
 Door Style = 2-Panel 3/4 Lite
 Door Cut Out = None
 Door Finish Type = Stained
 Door Finish - Exterior Side = Coffee Bean
 Door Finish - Interior Side = Coffee Bean
 Unit Type = Slab Only
 Operation / Venting = Right
 Swing Option = Right Inswing
 Unit Spec = All Products
 Building Code = Non-Certified
 Energy Star Needed = No
 Overhang Flyer = Yes
 Door Glass Insert Size & Shape = 22 x 48 Rectangle
 Door Glass Insert Option = Decorative
 Door Glass Type = Standard Glass
 Door Glass = Arum
 Door Glass Caming = Patina
 Door Glazing Type = Triple Insulated
 Door Glass Texture/Privacy = None
 Door Glass Privacy Rating = 8
 Door Order Method = Store Delivery
 Overall Frame Width = 35.75
 Overall Frame Height = 79
 Overall Rough Opening Width = 36.75
 Overall Rough Opening Height = 79.75



VOID

Quote Summary:

Line #	Item Summary	Price	Qty	Total Price
100-1	Entry Fiberglass Doors Slab Only Right 35.75 x 79 Design-Pro Mahogany Coffee Bean	\$1,000.79	1	\$1,000.79
Pretax Total Price:				\$1,000.79

VOID

VICTOR HARABIN
731 SO. BOYLIN
RALEIGH, NC 27603
9198100805

CARY
2031 WALNUT STREET
CARY, NC 27518

3615
311136
BRUCE

100-1

JELD-WEN
Entry Doors

Entry Fiberglass Doors Slab Only Slab Only Right 31.75 x 79

\$793.33

\$793.33

Call Width = 32
Call Height = 80
Include Lockset = No
Kickplate Installed = 32" Door - 6" x 30"
Kickplate Finish = Oil Rubbed Bronze
Door Bore = Double Bore
Bore Backset = 2 3/8"
Lockset Bore Position = 44"
Dead Bolt Bore Position = 5 1/2"
Bore Diameter = 2 1/8"
Hinge Prep = None
Manufacturer = JELD-WEN, Pottsville (UV)
Customer Service = 1.800.246.9131
Catalog Version Date = 05/06/2014
Room Location = Foyer/Entry
Reorder = No
Door Skin = Smooth-Pro
Door Type = Doors with Inserts
Door Thickness = 1 3/4"
Door Style = 1-Panel 3/4 Lite
Door Cut Out = None
Door Finish Type = Painted
Door Finish - Exterior Side = Mesa Red
Door Finish - Interior Side = Brilliant White
Unit Type = Slab Only
Operation / Venting = Right
Swing Option = Right Inswing
Unit Spec = All Products
Building Code = Non-Certified
Energy Star Needec = Yes
Overhang Flyer = Yes
Door Glass/Insert Size & Shape = 22 x 48 Rectangle
Door Glass Insert Option = Non-Decorative
Door Glass Type = Standard Glass
Door Glass = 1-Lite
Door Glazing Type = Insulated
Door Glass Texture/Privacy = Clear
Door Glass Privacy Rating = 1
Door insert Grille = None
Door Order Method = Store Delivery
Overall Frame Width = 31.75
Overall Frame Height = 79
Overall Rough Opening Width = 32.75
Overall Rough Opening Height = 79.75

VOID

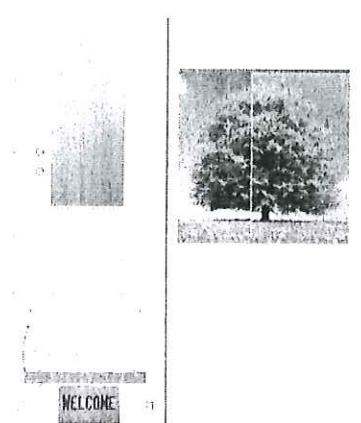

Quote Summary:

Line #	Item Summary	Price	Qty	Total Price
100-1	Entry Fiberglass Doors Slab Only Right 31.75 x 79 Smooth-Pro Mesa Red	\$793.33	1	\$793.33
			Pretax Total Price:	\$793.33

VOID