

CERTIFICATE OF APPROPRIATENESS PLACARD

for Raleigh Historic Resources

542 E JONES STREET

Address

OAKWOOD

Historic District

Historic Property

172-13-MW

Certificate Number

10/31/2013

Date of Issue

4/30/2014

Expiration Date

Project Description:

- Remove diseased and dangerous pecan tree;
- plant new tree

This card must be kept pasted in a location within public view until all phases of the described project are complete. The work must conform with the code of the City of Raleigh and laws of the state of North Carolina. When your project is complete, you are required to ask for a final zoning inspection in a historic district area. Telephone the RHDC office at 832-7238 and commission staff will coordinate the inspection with the Inspections Department. If you do not call for this final inspection, your Certificate of Appropriateness is null and void.

Signature, _____

Raleigh Historic Development Commission

A large, stylized handwritten signature in black ink, which appears to read "David Sully", is written over the signature line and extends into the adjacent area.



Planning & Development

Development Services
 Customer Service Center
 One Exchange Plaza
 1 Exchange Plaza, Suite 400
 Raleigh, North Carolina 27601
 Phone 919-996-2495
 eFax 919-996-1831

Raleigh Historic Development Commission – Certificate of Appropriateness (COA) Application



- Minor Work (staff review) – 1 copy
- Major Work (COA Committee review) – 13 copies
 - Most Major Work Applications
 - Additions Greater than 25% of Building Square Footage
 - New Buildings
 - Demo of Contributing Historic Resource
- Post Approval Re-review of Conditions of Approval

For Office Use Only

Transaction # 379767

File # 172-13-MW

Fee \$28

Amt Paid \$28

Check # cc.

Rec'd Date 10/31/13

Rec'd By AKW

• If completing by hand, please use **BLACK INK**. Do not use blue, red, any other color, or pencil as these do not photocopy.

Property Street Address 542 E. Jones St. Raleigh NC

Historic District _____

Historic Property/Landmark name (if applicable) Oakwood

Owner's Name Karen Stile

Lot size _____ (width in feet) _____ (depth in feet)

For applications that require review by the COA Committee (Major Work), provide addressed, stamped envelopes to owners of all properties within 100 feet (i.e. both sides, in front (across the street), and behind the property) not including the width of public streets or alleys:

Property Address	Property Address

I understand that all applications that require review by the commission's Certificate of Appropriateness Committee must be submitted by 4:00 p.m. on the application deadline; otherwise, consideration will be delayed until the following committee meeting. An incomplete application will not be accepted.

Type or print the following:

Applicant Tim Robbins

Mailing Address 4236 Rockside Hills Dr.

City Raleigh State NC Zip Code 27603

Date 10-31-2013 Daytime Phone 919-245-1985

Email Address info@arbormax.com

Signature of Applicant T. Robbins

Minor Work Approval (office use only)

Upon being signed and dated below by the Planning Director or designee, this application becomes the Minor Work Certificate of Appropriateness. It is valid until 4/30/14. Please post the enclosed placard form of the certificate as indicated at the bottom of the card. Issuance of a Minor Work Certificate shall not relieve the applicant, contractor, tenant, or property owner from obtaining any other permit required by City Code or any law. Minor work projects not approved by staff will be forwarded to the Certificate of Appropriateness Committee for review at the next scheduled meeting.

Signature [Signature] Date 10/31/13

Project Categories (check all that apply):

- Exterior Alteration
- Addition
- New Construction
- Demolition

Will you be applying for state or federal rehabilitation tax credits for this project?

- Yes
- No

(Office Use Only)

Type of Work _____

76

Design Guidelines Please cite the applicable sections of the design guidelines (www.rhdc.org).

Section/Page	Topic	Brief Description of Work
* Owner also had assessment by Randolph Harrison w/ US Forest Service. ^{IGT}	of similar species	Emergency Removal of Hazardous Pecan partial failure has occurred and the remaining portion of the tree is endangering the home.
* A new tree will be planted on the property to replace tree.		ISA Certified arborist #50-61500

For phone conversation with ~~applicant~~ owner. ^{IGT}
 Andrew Leeger

	TO BE COMPLETED BY APPLICANT		TO BE COMPLETED BY CITY STAFF		
	YES	N/A	YES	NO	N/A
Attach 8-1/2 " x 11" sheets with written descriptions and drawings, photographs, and other graphic information necessary to completely describe the project. Use the checklist below to be sure your application is complete.					
Minor Work (staff review) – 1 copy					
Major Work (COA Committee review) – 13 copies					
1. Written description. Describe clearly and in detail the nature of your project. Include exact dimensions for materials to be used (e.g. width of siding, window trim, etc.)	<input type="checkbox"/>		✓		
2. Description of materials (Provide samples, if appropriate)	<input type="checkbox"/>				✓
3. Photographs of existing conditions are required. <i>Tania has Photos</i>	<input type="checkbox"/>		✓		
4. Paint Schedule (if applicable)	<input type="checkbox"/>	<input type="checkbox"/>			✓
5. Plot plan (if applicable). A plot plan showing relationship of buildings, additions, sidewalks, drives, trees, property lines, etc., must be provided if your project includes any addition, demolition, fences/walls, or other landscape work. Show accurate measurements. You may also use a copy of the survey you received when you bought your property. Revise the copy as needed to show existing conditions and your proposed work.	<input type="checkbox"/>	<input type="checkbox"/>			✓
6. Drawings showing proposed work <ul style="list-style-type: none"> <input type="checkbox"/> Plan drawings <input type="checkbox"/> Elevation drawings showing the new façade(s). <input type="checkbox"/> Dimensions shown on drawings and/or graphic scale. <input type="checkbox"/> 8-1/2" x 11" reductions of full-size drawings. If reduced size is so small as to be illegible, make 8-1/2" x 11" snap shots of individual drawings on the big sheet. 	<input type="checkbox"/>	<input type="checkbox"/>			✓
7. Stamped envelopes addressed to all property owners within 100 feet of property not counting the width of public streets and alleys. (Required for Major Work)	<input type="checkbox"/>	<input type="checkbox"/>			✓
8. Fee (See <u>Development Fee Schedule</u>)	<input type="checkbox"/>				

The trunk has a large cavity w/ decay in the strapwood. Abt 85% of trunk is decayed.
 Per Tim Robbins conversation
 TGT

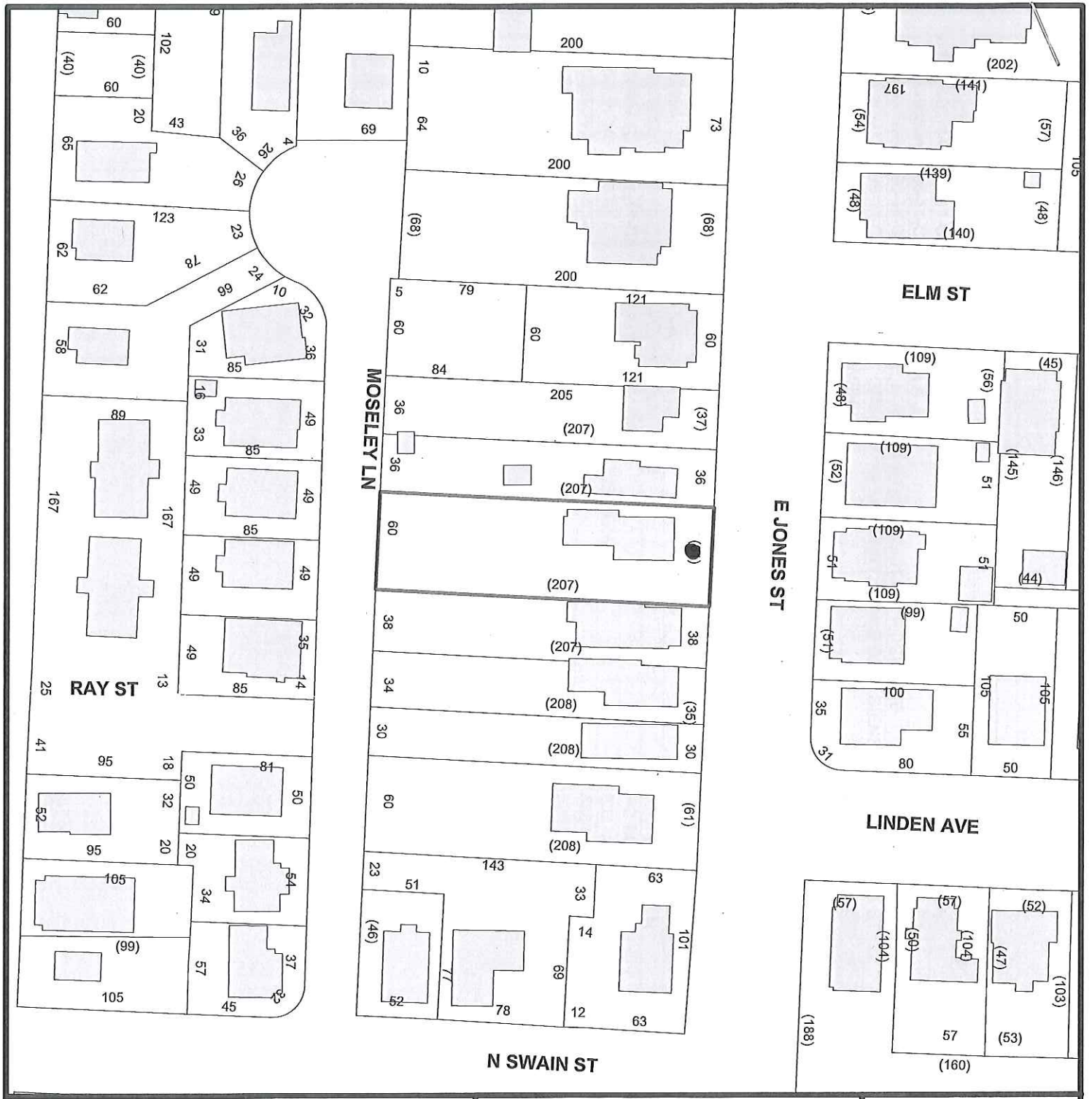



20131031_085505



20131031_085545



20131031_085557