

CERTIFICATE OF APPROPRIATENESS PLACARD

for Raleigh Historic Resources

1021 W SOUTH STREET

Address

BOYLAN HEIGHTS

Historic District

Historic Property

153-13-MW

Certificate Number

10/11/2013

Date of Issue

4/11/2014

Expiration Date

Project Description:

- Remove two diseased and dangerous trees;
- plant two new trees

This card must be kept pasted in a location within public view until all phases of the described project are complete. The work must conform with the code of the City of Raleigh and laws of the state of North Carolina. When your project is complete, you are required to ask for a final zoning inspection in a historic district area. Telephone the RHDC office at 832-7238 and commission staff will coordinate the inspection with the Inspections Department. If you do not call for this final inspection, your Certificate of Appropriateness is null and void.

Signature, _____
Raleigh Historic Development Commission

10.1.13

FOR: HISTORIC PROPERTIES
RE: TREE REMOVAL

4 PAGES



Planning & Development

Development Services
Customer Service Center
One Exchange Plaza
1 Exchange Plaza, Suite 400
Raleigh, North Carolina 27601
Phone 919-996-2495
eFax 919-996-1831

Raleigh Historic Development Commission – Certificate of Appropriateness (COA) Application



- Minor Work (staff review) – 1 copy
- Major Work (COA Committee review) – 13 copies
- Most Major Work Applications
- Additions Greater than 25% of Building Square Footage
- New Buildings
- Demo of Contributing Historic Resource
- Post Approval Re-review of Conditions of Approval

For Office Use Only

Transaction # 377377

File # 153-13-MW

Fee \$28.00

Amt Paid \$28.00

Check # 6653

Rec'd Date 10-7-13

Rec'd By K Pruitt

• If completing by hand, please use BLACK INK. Do not use blue, red, any other color, or pencil as these do not photocopy.

Property Street Address 1021 W. SOUTH ST. RALEIGH. NC 27603

Historic District BOYLAN HEIGHTS

Historic Property/Landmark name (if applicable)

Owner's Name KRISTIN PETERSEN / BRUCE MARKEY

Lot size (width in feet) 50' (depth in feet) 100'

For applications that require review by the COA Committee (Major Work), provide addressed, stamped envelopes to owners of all properties within 100 feet (i.e. both sides, in front (across the street), and behind the property) not including the width of public streets or alleys:

Property Address	Property Address

I understand that all applications that require review by the commission's Certificate of Appropriateness Committee must be submitted by 4:00 p.m. on the application deadline; otherwise, consideration will be delayed until the following committee meeting. An incomplete application will not be accepted.

Type or print the following:

Applicant **KRISTIN PETERSEN**

Mailing Address **1021 W. SOUTH ST.**

City **RALEIGH** State **NC** Zip Code **27603**

Date **9.9.13** Daytime Phone **919.8330641 6168634**

Email Address **RMARKEY@BELLSOUTH.NET**

Signature of Applicant *Kristin Petersen*

Minor Work Approval (office use only)

Upon being signed and dated below by the Planning Director or designee, this application becomes the Minor Work Certificate of Appropriateness. It is valid until 4/11/14. Please post the enclosed placard form of the certificate as indicated at the bottom of the card. Issuance of a Minor Work Certificate shall not relieve the applicant, contractor, tenant, or property owner from obtaining any other permit required by City Code or any law. Minor work projects not approved by staff will be forwarded to the Certificate of Appropriateness Committee for review at the next scheduled meeting.

Signature *[Signature]* Date 10/17/13

Project Categories (check all that apply):

- Exterior Alteration
- Addition
- New Construction
- Demolition **TREES (2)**

Will you be applying for state or federal rehabilitation tax credits for this project?

- Yes
- No

(Office Use Only)

Type of Work _____

76

Design Guidelines Please cite the applicable sections of the design guidelines (www.rhdc.org).

Section/Page	Topic	Brief Description of Work
		<i>Tree removal & replacement</i>

TO BE COMPLETED BY APPLICANT			TO BE COMPLETED BY CITY STAFF		
	YES	N/A	YES	NO	N/A
<p>Attach 8-1/2 " x 11" sheets with written descriptions and drawings, photographs, and other graphic information necessary to completely describe the project. Use the checklist below to be sure your application is complete.</p> <p>Minor Work (staff review) – 1 copy</p> <p>Major Work (COA Committee review) – 13 copies</p>		X			
<p>1. Written description. Describe clearly and in detail the nature of your project. Include exact dimensions for materials to be used (e.g. width of siding, window trim, etc.) REMOVAL OF 2 TREES (ELM)</p>	<input checked="" type="checkbox"/>		✓		
<p>2. Description of materials (Provide samples, if appropriate)</p>	<input type="checkbox"/>	NA			
<p>3. Photographs of existing conditions are required. SEE LINEBERGER REPORT</p>	<input checked="" type="checkbox"/>				
<p>4. Paint Schedule (if applicable)</p>	<input type="checkbox"/>	<input checked="" type="checkbox"/>			✓
<p>5. Plot plan (if applicable). A plot plan showing relationship of buildings, additions, sidewalks, drives, trees, property lines, etc., must be provided if your project includes any addition, demolition, fences/walls, or other landscape work. Show accurate measurements. You may also use a copy of the survey you received when you bought your property. Revise the copy as needed to show existing conditions and your proposed work.</p>	<input type="checkbox"/>	<input checked="" type="checkbox"/>			✓
<p>6. Drawings showing proposed work</p> <ul style="list-style-type: none"> <input type="checkbox"/> Plan drawings <input type="checkbox"/> Elevation drawings showing the new façade(s). <input type="checkbox"/> Dimensions shown on drawings and/or graphic scale. <input type="checkbox"/> 8-1/2" x 11" reductions of full-size drawings. If reduced size is so small as to be illegible, make 8-1/2" x 11" snap shots of individual drawings on the big sheet. 	<input type="checkbox"/>	<input checked="" type="checkbox"/>			✓
<p>7. Stamped envelopes addressed to all property owners within 100 feet of property not counting the width of public streets and alleys. (Required for Major Work)</p>	<input type="checkbox"/>	<input type="checkbox"/>			✓
<p>8. Fee (See Development Fee Schedule)</p>	<input type="checkbox"/>				



Lineberger's Tree Service, Inc

5404 Penny Road
Raleigh, North Carolina
27606-9303

Phone # 919-834-0055
Fax # 919-834-8910

BeverlyLineberger@LinebergerTre...
www.LINEBERGERTREE.com

Estimate

Date	Estimate #
9/25/2013	2011-8132

Name / Address
Bruce Markey & Kristin Peterson 1021 W South Street Raleigh, NC 27603

Description	Time (Hours)	Rate	Total
Tree care estimate provided by Arborist Eric Smith on 09/25/2013:		0.00	0.00
1) Complete removal of 1 large, declining elm tree located in the right rear yard just inside fence line. This leaning tree has a co-dominant top and the right side, which is ~ 50% of the entire canopy, is completely dead. There are also outwardly visible signs of Ambrosia beetles around the base of the tree. This entire tree is dying and is currently a hazard and should be removed. We will utilize and set-up our self-propelled man lift in multiple locations to safely piece this tree down in small sections. The stump will be cut as low to the ground as possible and all material will be neatly removed from the property.		1,500.00	1,500.00
2) Complete removal of 1 tall, declining elm tree located just outside of the left rear fence line. The canopy of this tree is currently 30% dead and the lower stem has decay holes present. As the canopy of this tree continues to die, and the decay in the base progresses, it will become an increased hazard. I recommend removing it now rather than waiting for sections to fall out. The stump will be cut as low to the ground as possible and all material will be neatly removed from the property.		300.00	300.00
All appropriate safety equipment will be used. Insurance documents are gladly available upon request, for worker's comp. and general liability. Work will be performed to ANSI and ISA Standards. Sales Tax			0.00
		6.75%	0.00
Please take a moment to visit our web site at www.LinebergerTree.com to find out why our company offers the best "value" and most professional experience in our industry.	Total		\$1,800.00

tree one

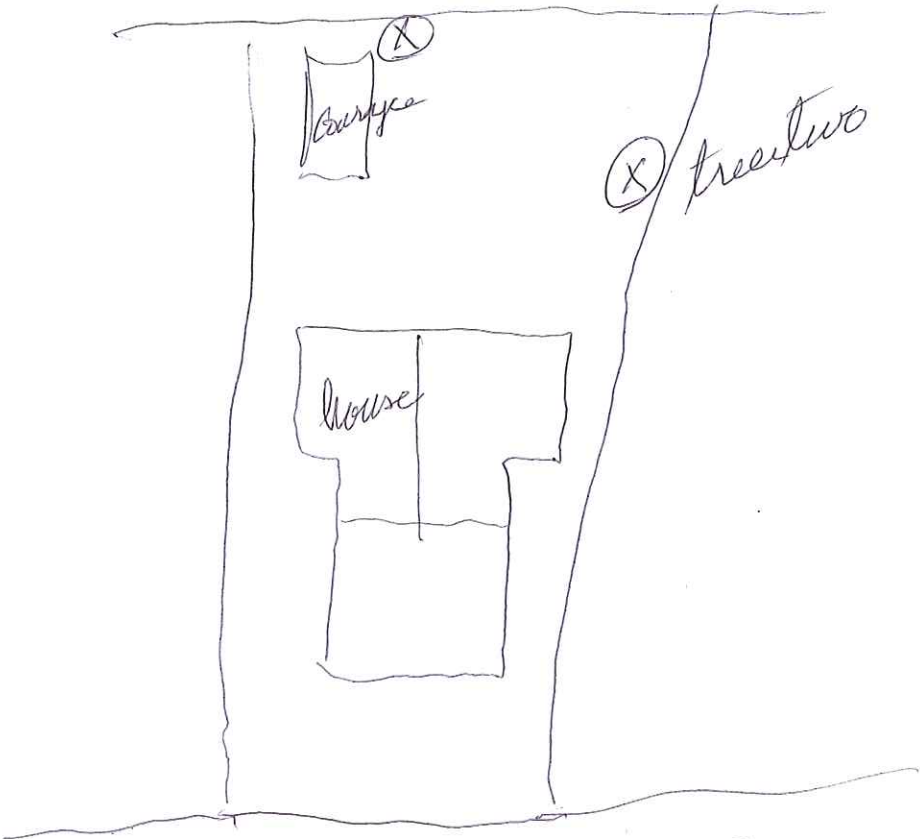

1021 W. South St

Tully, Tania

From: Tully, Tania
Sent: Friday, October 11, 2013 1:35 PM
To: Kristin Petersen (rmarkey@bellsouth.net)
Subject: COA for Tree Removal - More info needed
Attachments: NeighborWoodsDonationForm (2).doc

Kristin –

I am reviewing the COA application for tree removals at 1021 W South Street and need additional information before I can complete the review.

- Please provide photographs of the trees proposed for removal.
- For the application to be reviewed as a Minor Work, the removals must be accompanied by replacement trees. If evidence is provided that there is no appropriate location for new trees to be placed on the property, the replacement may be substituted by a donation to the NeighborWoods tree planting program (approximately \$50 per tree). The donation form is attached should you choose that route. I will forward the donation to the program with the notation that the trees are specifically for the Boylan Heights historic district.
- Should replacement trees not be proposed, the item is classified as a Major Work to be decision by the COA Committee and the following additional information provided:
 - Additional \$114 to cover the application fee.
 - 12 copies of the complete application package (not counting the original)
 - Stamped envelopes addressed to property owners within 100 feet of the property, not counting the public right-of-way.

Please let me know if you have any questions.

Thanks!
Tania

Tania Georgiou Tully, Preservation Planner
Long Range Planning Division
Raleigh Department of City Planning
919.996.2674 **new phone number**
919.516.2682 (fax)
tania.tully@raleighnc.gov

Tania Georgiou Tully

From: Kristin Petersen <rmarkey@bellsouth.net>
Sent: Friday, October 11, 2013 3:18 PM
To: ttully@rhdc.org
Subject: our replacement trees

Hi Tania,

We plan to replace our two Elms with:

Flowering Dogwood, cornus florida in the back yard Chain flowered Redbud, cercis recemon in the side yard

Let me know if you need anything else.

many thanks.

Kristi Petersen
rmarkey@bellsouth.net
919 616 8639

Tania Georgiou Tully

From: Kristin Petersen <rmarkey@bellsouth.net>
Sent: Friday, October 11, 2013 2:52 PM
To: ttully@rhdc.org
Subject: trees at 1021 W South st
Attachments: tree1.JPG; tree2.JPG; beetlevidence.JPG

Hello Tania,

Please find attached, three photos showing the bower of our two sick elms. The third photo shows evidence of a beetle mentioned by the arborist. kinda hard to see after it has been rained on.

I will call you in a minute. Thanks!

Kristi Petersen
rmarkey@bellsouth.net
919 616 8639



tree2



beetlevidence



tree1